

Culligan® Preferred™ Series Drinking Water Filters Installation, Operation, and Service Guide

SPECIFICATIONS

Operating Pressure Range: 10 - 125 psi (0.7 bar - 8.6 bar)
Operating Temperature Range: 35 - 100°F (2 - 38°C)
Service Flow Rate: 0.5 gpm (1.9 Lpm)

CERTIFIED PERFORMANCE

The Culligan Preferred 150, Preferred 250, and Preferred 350 Drinking Water Filters have been tested and Certified to ANSI/NSF International Standard 42 and ANSI/NSF International Standard 53 for the substances listed below as verified and substantiated by test data.

Standard No. 42: Aesthetic Effects

Chemical Unit

Taste and Odor and Chlorine Reduction, Class I

Mechanical Filtration Unit

Particulate Reduction, Class I:
99.9% reduction of particles
1/2 micron and larger in size

Standard No. 53: Health Effects

Chemical Reduction Unit

VOC Reduction (Preferred 350 Filter only)

Lead Reduction

Mechanical Filtration Unit

Turbidity Reduction

Cyst Reduction

Asbestos Reduction

Do not use where water is microbiologically unsafe or with water of unknown quality without adequate disinfection before or after the system. These systems may be used on disinfected waters that may contain filterable cysts. The contaminants and other substances removed or reduced by these systems are not necessarily in your water. Check for compliance with state and local laws and regulations. Note that some states require licensed installers, and some states prohibit the use of saddle valves.

INSTALLATION

Culligan recommends that Preferred Series Drinking Water Filters be installed with a faucet dedicated to dispensing only filtered water. Such a faucet is available from Culligan by ordering PN 01-0035-37. Refer to the plumbing schematic shown in **Figure 1** when completing this type of installation. Other recommended applications include point-of-use drinking water coolers, refrigerators, and ice makers.

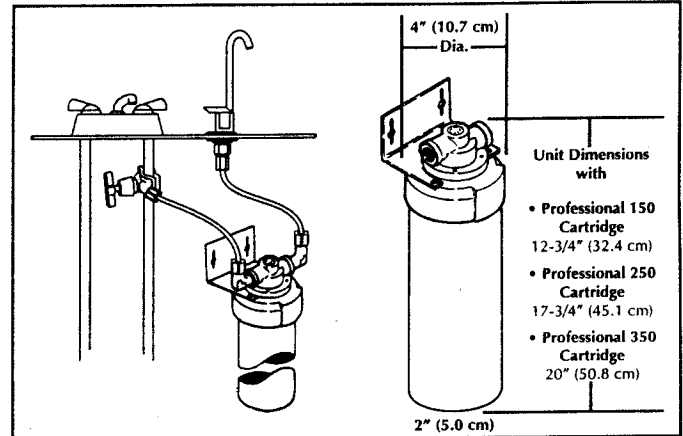

This filter system is supplied with fittings which are designed for use with 1/4 inch O.D. polyethylene tubing; available from Culligan by ordering PN 00-4021-84.

- Select a location for the filter assembly which:
 - Provides a solid mount for the filter head.
 - Allows a minimum 2 inches (5 cm) of clearance under the cartridge.
 - Allows space for inlet and outlet water line connections.

Note: The filter must be mounted vertically.
- Provide an inlet water supply for the filter by tapping the cold water line. This connection should accommodate 1/4 inch O.D. polyethylene tubing and must comply with state and local laws and regulations.
- Install the faucet or dispensing device according to the instructions provided with the device.
- Refer to **Figure 2** to determine the best filter bracket position to accommodate the water connections.
- Install the 0.5 gpm flow restrictor fitting into the outlet port on the filter head using PTFE tape.

Note: The restrictor is built into one of the elbow fittings.
- Install the remaining 1/4 inch tubing fitting into the filter head inlet using PTFE tape.
- Mount the filter head using the screws and washers provided.
- Connect the inlet and outlet tubing to the inlet and outlet fittings of the filter. Double check the water connections to be sure that water will follow the direction-of-flow arrow on top of the head; water supply to inlet fitting, outlet fitting to faucet.
- Install the filter cartridge as detailed in **Figure 3**.
- Flush the cartridge for a few minutes to purge the system of air.

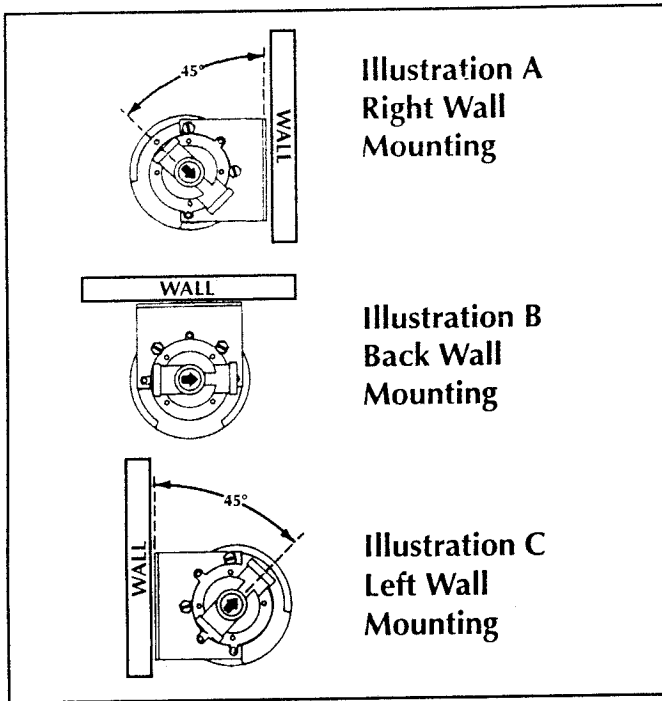

Figure 2

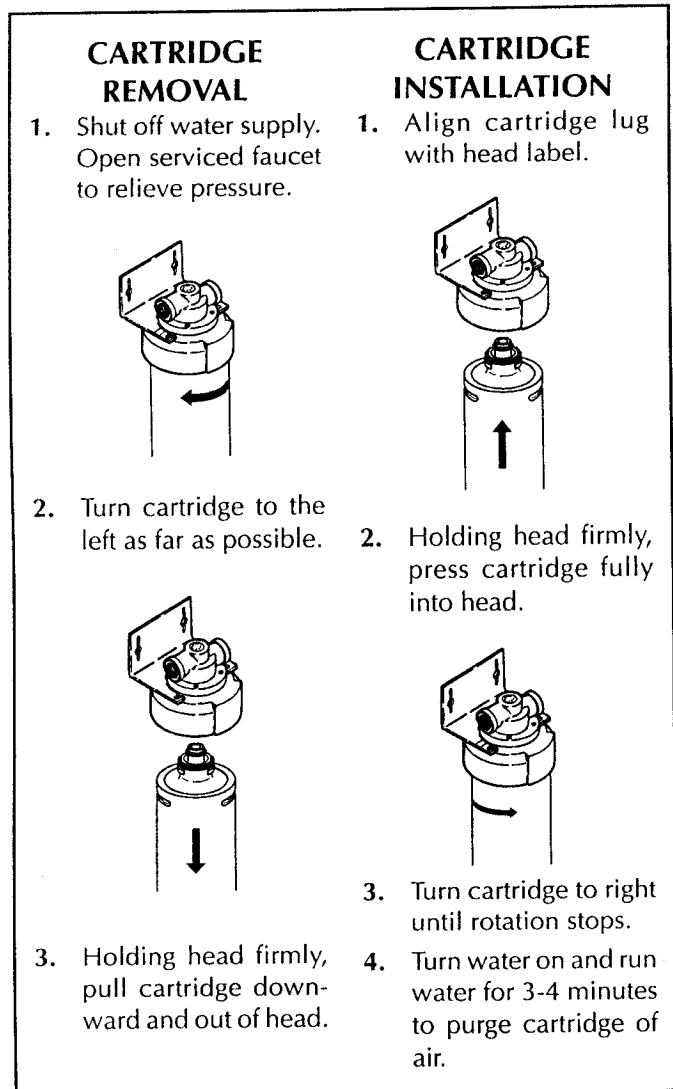

Figure 3

FILTER REPLACEMENT

These drinking water systems must be maintained according to the manufacturer's instructions, including timely replacement of filter cartridges. Follow the guidelines below to determine when the filter cartridge must be replaced in each system. Refer to **Figure 3** for the service sequence.

Preferred™ 150 Filter

The filter cartridge must be replaced after every 750 gallons or one year of use (whichever comes first), or whenever there is a change in taste or odor or a noticeable decrease in flow. 750 gallons of water use is roughly equivalent to using 2 gallons of water daily for one year.

Preferred™ 250 Filter

The filter cartridge must be replaced after every 1000 gallons or one year of use (whichever comes first), or whenever there is a change in taste or odor or a noticeable decrease in flow. 1000 gallons of water use is roughly equivalent to using 2-1/2 gallons of water daily for one year.

Preferred™ 350 Filter

The filter cartridge must be replaced after every 300 gallons or one year of use (whichever comes first), or whenever there is a change in taste or odor or a noticeable decrease in flow. 300 gallons of water use is roughly equivalent to using 1-1/2 gallons of water daily for six months. Filter life may be extended to 500 gallons when the Preferred 350 Filter is used with a metering device Certified by NSF International under ANSI/NSF Std. 53.

Replacement Cartridge Part Numbers

Preferred 150 Filter	01-0028-68
Preferred 250 Filter	01-0028-69
Preferred 350 Filter	01-0028-70

Replaceable components and service parts are available through your local independent Culligan dealer. To learn the name of your nearest dealer, contact:

CULLIGAN INTERNATIONAL COMPANY

One Culligan Parkway

Northbrook, IL 60062

USA

(847) 205-6000

<http://www.culligan-man.com>